

| Male Changing Room A                                |    |
|---|----|
| LOCKER TOTALS<br>MALE CHANGE A                      |    |
| GOLF LOCKERS  | 40 |
| Double Width GOLF LOCKERS<br>(accommodating 4 bags) | 2  |
| HOLDALL LOCKERS                                     | 11 |
| HANGING SPACES                                      | 21 |

| Male Changing Room B                                   |    |
|--|----|
| LOCKER TOTALS<br>MALE CHANGE B                         |    |
| GOLF LOCKERS   | 43 |
| Double Width GOLF LOCKERS<br>(accommodating 4 bags)    | 2  |
| HOLDALL LOCKERS (Permanent Rental)                     | 15 |
| HOLDALL LOCKERS (*Coin Operated)                       | 12 |
| Double Width HOLDALL LOCKERS<br>(accommodating 4 bags) | 2  |
| HANGING SPACES   | 40 |

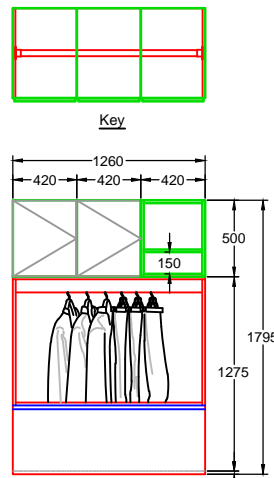

Type WbHd3 Wardrobe  
1:25  
610mm deep inc holdall  
\* For lock and number disc  
details refer to quote  
Male A 1 No Type WbHd3 Wardrobes giving  
21 No Hanging Spaces  
3 No Holdall Lockers  
Male B

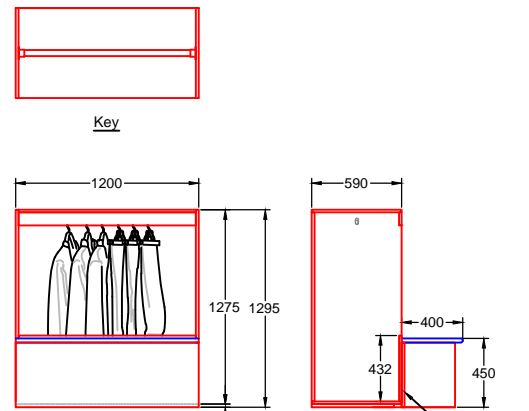

Type Wb Wardrobe  
1:25  
590mm Deep  
Male A  
Male B 2 No Type Wb Wardrobes giving  
40 No Hanging Spaces

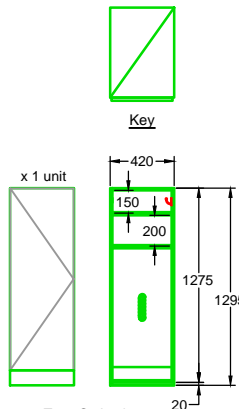
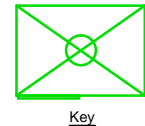

\* For lock and number disc  
details refer to quote  
Male A 3 No Type Sg Locker Units giving  
3 No Golf Lockers

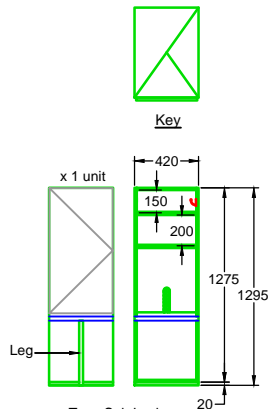

\* For lock and number disc  
details refer to quote  
Male B 1 No Type Sg Locker Units giving  
1 No Golf Lockers

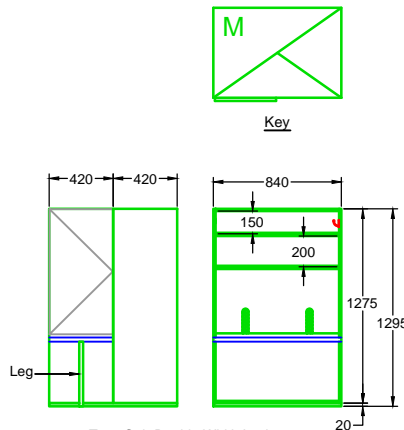

\* For lock and number disc  
details refer to quote  
Male B 1 No Type Sgb Double Width Locker Units giving  
2 No Double Width Golf Lockers  
(\* Mullion Hanging)

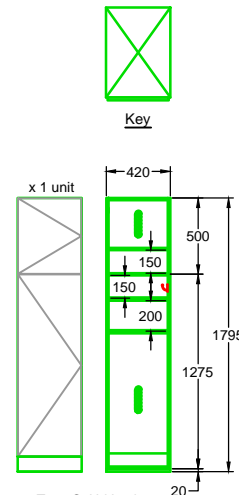

\* For lock and number disc  
details refer to quote  
Male B 1 No Type SgHd Locker Units giving  
8 No Golf Lockers and  
8 No Holdall Lockers

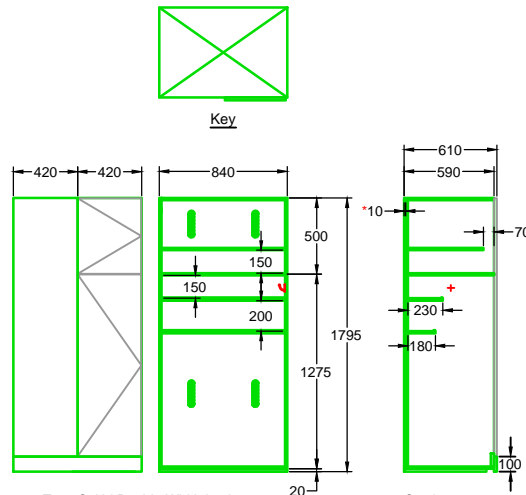

\* For lock and number disc  
details refer to quote  
Male B 1 No Type SgHd Double Width Locker Units giving  
1 No Golf Lockers and  
1 No Holdall Lockers  
(\* Gable Hanging)

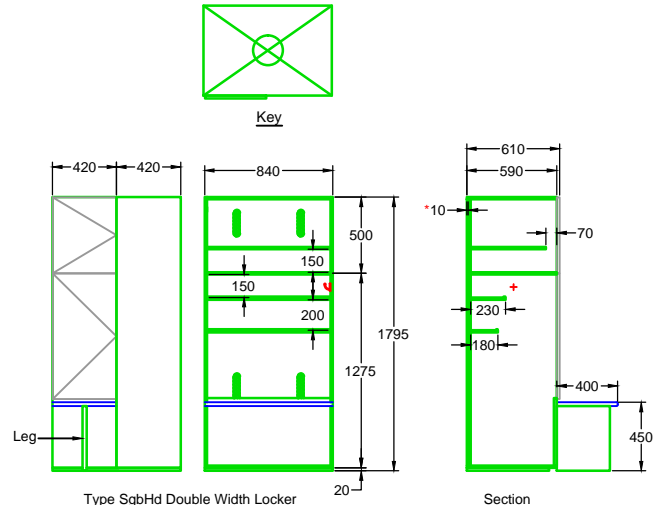

Type SgbHd Double Width Locker  
1:25  
610mm Deep  
Male B 1 No Type SgbHd Double Width Locker Units giving  
1 No Golf Lockers and  
1 No Holdall Lockers  
(\* Mullion Hanging)

THIS DRAWING HAS BEEN PREPARED FROM THE  
FOLLOWING INFORMATION:  
Arch's Drg No \_\_\_\_\_  
Customers Drg/sketch \_\_\_\_\_  
Contract Mgr's Survey \_\_\_\_\_  
Not Applicable \_\_\_\_\_  
APPROVED BY: \_\_\_\_\_  
Position: \_\_\_\_\_  
Date: \_\_\_\_\_

COPYRIGHT IS RESERVED  
BY CRAFTSMAN LOCKERS

This drawing is the property of Craftsman Lockers Ltd.  
Copyright is reserved by them and the drawing is issued  
on the condition that it is not copied either wholly or in part  
without the consent in writing of Craftsman Lockers Ltd.

A All Lockers to now be fitted on a 20mm Plinth. Room A - All Lockers with a Bench in front changed to allow the Compartments to drop down behind the Bench.  
1 No WbHd3 Wardrobe replaced with Golf Lockers. Room B - 12 No Holdalls Lockers indicated to have Coin Operated Locks. Radiator indicated by Client.  
KLA 03.04.14

|   |                  |              |
|---|------------------|--------------|
| iss                                     | By               | Date         |
| Client<br>Knighton Heath Golf Club      |                  |              |
| Drawing<br>Male Changing<br>Rooms A & B |                  |              |
| Scale<br>1:25/50                        | Date<br>06.08.12 | Drawn<br>KLA |
| Project<br>P03497-03                    | Checked<br>A     |              |